

ANTARA - SOPA PACKAGE

BENNALONG PKWY, SYDNEY OLYMPIC PARK

LANDSCAPE DOCUMENTATION

SHEET PLAN 1:500

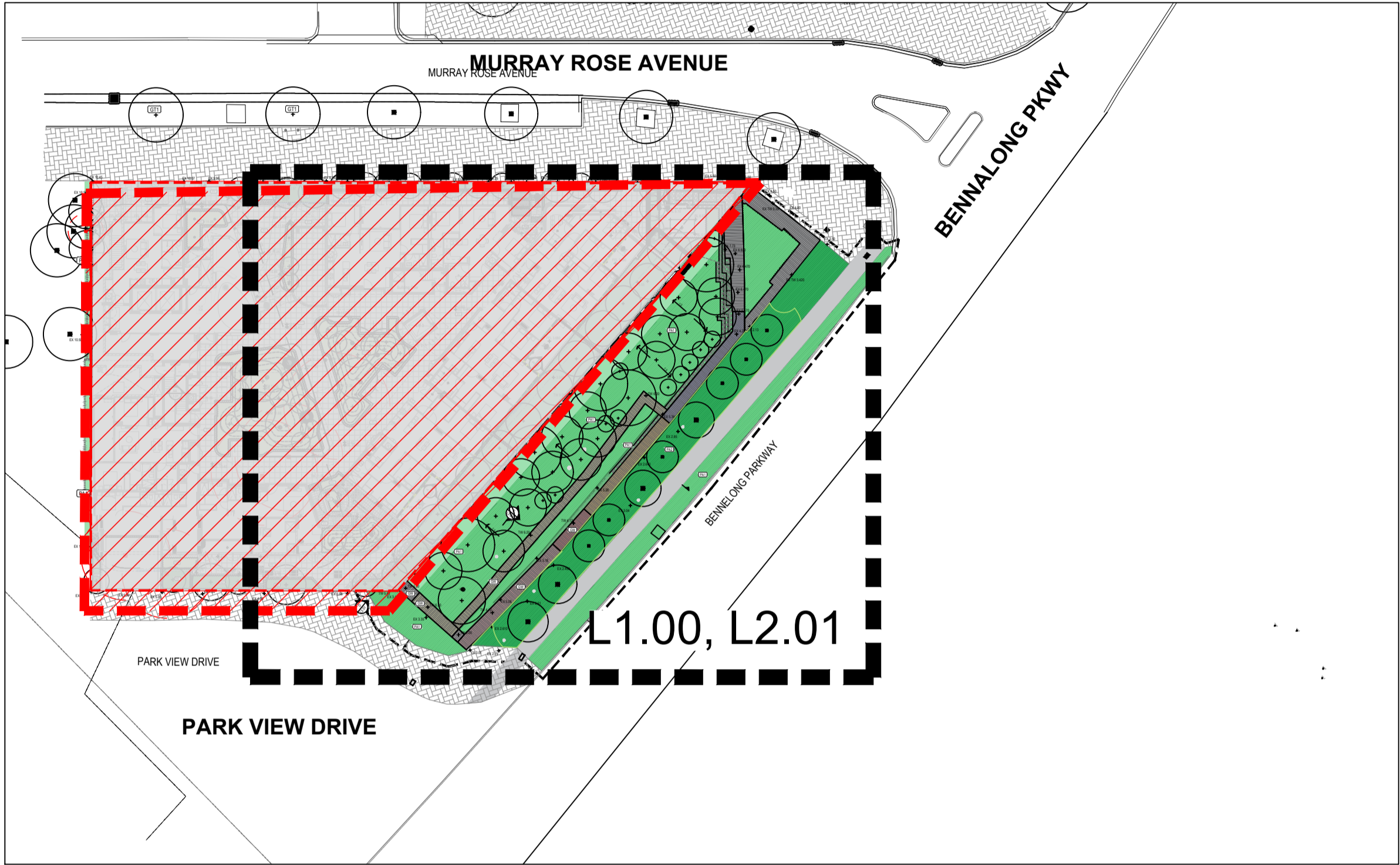

DRAWING SCHEDULE

DWG No.	Drawing Title
L0.00	Coversheet and Drawing Schedule
L0.01	Maintenance Schedule
L0.02	Material Schedule
L1.00	Landscape Plan
L1.10	Deep Soil Plan
L2.00	Planting Schedule
L2.01	Planting Plan
L3.00	Sections
L3.01	Section and Elevation
L4.00	Details

1.0 These drawings must be read in conjunction with drawing packages from the consultant team including all engineering drawings and architectural drawings.

2.0 Do not scale from these drawings - use figured dimensions.

3.0 Services
Verify the 'as built' location of all existing services before excavation works are started. Services shown are indicative only.

4.0 Surface levels
final surface levels to be verified on site. All adjacent surfaces are to be level and flush unless stated or documented otherwise.

5.0 Falls
all pavement, planting & turf areas to be graded evenly. Ponding is unacceptable.

6.0 Materials & finishes
Refer schedule materials & finishes in specification for all elements contained within these drawings.

7.0 Design for access and mobility
All external works to comply with as 1428 parts 1 & 4. Longitudinal grades no steeper than 1 in 20 and crossfall grades no steeper than 1 in 40.

8.0 Planting
Refer planting schedule.

LEGEND 1:100

General

- Extent of works
- Antara Project Property boundary

Grading

- EX 0.000 Existing surface level (in millimetres)
- 0.000 Relative surface level

Softscape

- Existing tree To be retained
- Tree Refer to Detail Refer Schedule
- Shrubs
- PA1 Planting area In ground
- PA2 Planting area Swale planting
- Root Protection Zones Hand planting

Hardscape

- GW Gabion wall Refer to Schedule

rev	description	date	drawn	QA
A	FOR APPROVAL	2024-08-30	RG	BR
B	FOR APPROVAL	2024-09-06	RG	SH
C	FOR APPROVAL	2025-02-11	RG	SH
D	FOR APPROVAL	2025-04-28	RG	SH

NOT FOR CONSTRUCTION

D FOR APPROVAL 2025-04-28 RG SH



A TETRA TECH COMPANY

RPS AAP Consulting Pty Ltd
ABN 97 117 883 173

Sydney Office
Level 13, 420 George Street
Sydney NSW 2000

T +61 2 8099 3200
W rpsgroup.com

client

DECODE

project name

ANTARA - SOPA LAND

project location

BENNELONG PKY, SYDNEY OLYMPIC PARK

drawing title

COVER SHEET AND DRAWING SCHEDULE

AS SHOWN

scale



rev	description	date	drawn	QA
A	FOR APPROVAL	2025-02-11	RG	SH
B	FOR APPROVAL	2025-04-28	RG	SH

NOT FOR CONSTRUCTION

Deep Soil
Total Area: 728m2



A TETRA TECH COMPANY

RPS AAP Consulting Pty Ltd
ABN 97 117 883 173

Sydney Office
Level 13, 420 George Street
Sydney NSW 2000

T +61 2 8099 3200
W rpsgroup.com

client
DECODE

project name
ANTARA - SOPA LAND

project location
BENNELONG PKY, SYDNEY OLYMPIC PARK

drawing title
DEEP SOIL PLAN



Maintenance Needs:

Landscape works are to have a 24 month maintenance period to ensure the successful establishment of trees. The 24 month maintenance must be undertaken by the landscape contractor who carries out the works.

Maintenance Schedule & Recurrent Works:

Reputable landscape contractor to maintain horticultural practices, as well as rectifying defects that become apparent in the works under normal use including, but not limited to, the following items where required: watering, weeding, fertilising, pest and disease control, mowing, topdressing, reseeding, returfing, edging, renovating, pruning, rubbish removal and keeping the site neat and tidy.

The maintenance of the landscape will be undertaken by the landscape contractor for the first 24 months to ensure successful establishment. Following this the maintenance will be taken over by a maintenance contractor.

The maintenance to be undertaken will be detailed in the Landscape Maintenance Schedule. The Landscape Maintenance Schedule will ensure the necessary scope and level of maintenance is achieved to ensure the plants remain healthy and other landscape elements are maintained in a safe, functional and attractive condition and will include the following:

Mulched surfaces

- Maintain mulched surfaces in a clean and tidy condition and top up to the specified depth if necessary.

Soil subsidence

- Rectify soil subsidence or erosion which may occur after the soil filing and preparation operations.
- Throughout the establishment period, ensure pathways, pavements and road are kept clean of mulch, soils and landscape litter.
- Pruning- by landscape contractor. Pruning will be directed for the maintenance and dense foliage or miscellaneous pruning as beneficial to the condition of the plants. Prune damaged growth.

Shrub Pruning and Trimming

- Tip prune shrubs and ground covers to encourage density in spring and winter. Length removed depending on vigor of previous plant growth.
- Pruning should reflect the natural growth, flowering and regrowth habit of the individual species. Generally prune after flowering. Inspect for failed or dying plants requiring replacement monthly and record probable cause.
- All plants that have died or failed (lost more than 50% of their normal foliage cover) shall be replaced by the contractor with the same species and commercially available size as the plant to be replaced.
- Generally plant material shall be uniformly high quality stock equal to best available for 'retail sale'. The root systems shall be balanced in relation to the size of the plant. Plants shall be healthy well grown, hardened off specimens of good shape and free from pests and diseases and in accordance with 'Specifying Trees: a guide to assessment of tree quality' (Clark 2006).

Tree Maintenance

- Inspect trees monthly during the first 24 months and annually thereafter. Ensure trees are not showing any signs of stress, adjust watering as required to ensure good health and top up mulch to specified depths as required.
- Avoid unnecessary pruning during the first three years. Prune only critical branches and remove damaged or dead wood. Remove branches that limit public access or present a safety risk.
- Lift the crown of the trees to maintain clear site lines where required to a level of 1.2m.
- Structural tree work including the removal of large branches should be undertaken by a qualified arborist with appropriate applications for the works made to Council.

Turf Maintenance

- Topdress all turf during the last 3 weeks of the establishment period. Fill depressions / sinkages and gaps so that the turf finishes flush and even against adjoining surfaces and presents a smooth and uniform flat surface. All turfed areas are to be mown regularly so that the turf height remains uniform from week to week. All turfed areas are to be fertilized during this period.
- Mow turf every 2 weeks in summer, 3 weeks in Spring / Autumn and 4 weeks in winter, or as deemed necessary to maintain healthy form. Mow at heights of between 40 to-60mm & remove no more than 1/3 of the leaf blade at any one time. Do not mow under wet conditions.
- Apply fertiliser at rates as recommended by manufacturer in Spring and Autumn.
- Inspect for compaction and thatching in Spring. Carry out aeration treatment if required using dethatching or verticutting equipment.
- Inspect for failed turf requiring replacement and record probable cause in Winter. Remove failed turf, prepare surface & lay new turf in accordance with original turf specified.

Fertilising, Soil Improvement and Pest Control

- Soil testing is to be submitted for approval before the installation of soil on site. Slow release fertiliser selected to take into account the soil testing results and the insitu plants should be applied annually in spring and in accordance with the manufacturer's recommended rate. Prior approval required for fertiliser use.
- Check for incidence of fungal and insect attack monthly. Apply appropriate treatment for fungal and insect attack if necessary subject to approval.
- Avoid use of chemical sprays. If chemical control is considered necessary, these should be mixed and applied in strict accordance with manufacturer's directions. Do not spray in windy or extreme weather.
- Do not remove leaf litter from planted areas unless depth of litter is impacting on plant growth.

Mulch and Weeding:

- Remove rubbish and weed growth that may recur throughout the contract area, at weekly intervals, and maintain in a completely clean and tidy condition.
- Prevent reproduction of weeds by removal of seedlings and established weeds before seed set. This work should be carried out regularly so that the planted and mulched areas are weed free when observed at monthly intervals.
- Weed garden areas manually or with approved herbicide. Prior approval required for Herbicide use. Approved Herbicide use to be in accordance with regulation rates and manufacturer's recommendation. Protect plants from overspray and avoid if rain is likely within 12 hour period.
- Surface mulch is to be replenished as required, at least annually in spring, to maintain a consistent depth as specified at installation. Mulching materials to be consistent with those specified at installation.

Adjustment of Tree Stakes and Ties:

- Inspect stakes and ties monthly, replace as required. Check the straps during spring and autumn, ensuring they are loose around the tree to prevent damage to the trunk.
- Remove all stakes and ties at the completion of the 12 month establishment period.

Landscape Maintenance Schedule				
WEEK	SPRING (Sept, Oct, Nov)	SUMMER (Dec, Jan, Feb)	AUTUMN (Mar, Apr, May)	WINTER (Jun, Jul, Aug)
1	Mow and trim lawns	Mow lawns; weed	Mow lawns	Weed
2	Weed; trim and adjust trees and shrubs	Weed; mow lawns, trim and adjust trees and shrubs	Weed; mow lawns, trim and adjust trees and shrubs	Mow and trim lawns Trim and adjust trees and shrubs
3	Mow and fertilise lawns; treat plant material for pests and disease	Mow lawns; weed; treat plant material for pests and disease	Mow and trim lawn	Weed
4	Weed; top dress, condition lawns and oversow bare patches; issue maintenance report	Weed; mow and trim lawns; issue maintenance report	Weed; mow lawns; issue maintenance report	Mow lawns; issue maintenance report
5	Fertilise all trees and shrubs in garden beds; mow and trim lawns	Mow lawns; weed	Mow lawns	Mow lawns
6	Weed; inspect mulch for deficiencies in cover; check and adjust irrigation	Mow lawns; check and adjust irrigation	Weed; inspect mulch for deficiencies in cover; check and adjust irrigation	Mow and trim lawns; treat for pests and disease; check and adjust irrigation
7	Reinstate mulch as required; treat plant material for pests and disease; mow lawns	Mow lawns; weed	Reinstate mulch as required; mow, trim and fertilise lawns	Weed
8	Weed; inspect condition of paving and furniture; issue maintenance report	Mow and trim lawns; inspect condition of paving and furniture; issue maintenance report	Weed; inspect condition of paving and furniture; issue maintenance report	Mow lawns; Inspect condition of paving and furniture; issue maintenance report
9	Mow and trim lawns	Mow lawns; treat plant material for pests and disease	Mow lawns	Weed
10	Weed; mow lawns	Mow and top dress lawns	Weed; treat plant material for pests and disease	Mow and trim lawns
11	Mow and fertilise lawns; trim and adjust trees and shrubs	Mow lawns; trim and adjust lawns; weed	Mow and trim lawns; trim and adjust trees and shrubs	Prune back trees and shrubs after flowering
12	Weed; mow lawns; treat plant material for pests and disease	Mow, trim and fertilise lawns	Weed	Mow lawns; treat plant material for pests and disease
13	Check and adjust irrigation; mow lawns; issue maintenance report	Check and adjust irrigation; mow lawns; weed; issue maintenance report	Check and adjust irrigation; mow lawns; weed; issue maintenance report	Check and adjust irrigation; weed; issue maintenance report

rev	description	date	drawn	QA
A	FOR APPROVAL	2024-08-30	RG	BR
B	FOR APPROVAL	2024-12-17	RG	SH
C	FOR APPROVAL	2025-02-11	RG	SH

NOT FOR CONSTRUCTION





RPS AAP Consulting Pty Ltd
ABN 97 117 883 173

Sydney Office
Level 13, 420 George Street
Sydney NSW 2000

T +61 2 8099 3200
W rpsgroup.com

client
DECODE
project name
ANTARA - SOPA LAND
project location
BENNELONG PKY, SYDNEY OLYMPIC PARK
drawing title
MAINTENANCE SCHEDULE

NOT TO SCALE

Code	Specification	Image of Intent
PA1 Planting on ground	<p>Mulch: 75mm depth of 15mm Forest Fine</p> <p>Soil: Imported Soil Blend consisting of:</p> <p>Australian Native soil mix Type - A suitable commercially available product such as ANL Organic Garden Mix, or Benedicts SMARTMIX 6 native Garden Mix, or an approved equivalent manufactured garden soil with a maximum 20% organic matter by volume, may be used. - Depth: 300mm</p> <p>VENM subsoil Virgin Excavated Natural Material Depth: 500mm Contractor to ensure suitability for planting</p>	
PA2 Planting in swale	<p>Australian Native soil mix Type - A suitable commercially available product such as ANL Organic Garden Mix, or Benedicts SMARTMIX 6 native Garden Mix, or an approved equivalent manufactured garden soil with a maximum 20% organic matter by volume, may be used. - Depth: 200mm</p> <p>Apply jute mat (sample to be provided by contractor for approval) to all replanted areas</p>	

rev	description	date	drawn	QA
A	FOR APPROVAL	2024-12-17	RG	SH

NOT FOR CONSTRUCTION



A TETRA TECH COMPANY

RPS AAP Consulting Pty Ltd
ABN 97 117 883 173

Sydney Office
Level 13, 420 George Street
Sydney NSW 2000

T +61 2 8099 3200
W rpsgroup.com

client

DECODE

project name

RESPONSE TO CONDITION 13B

project location

BENNELONG PKY, SYDNEY OLYMPIC PARK

drawing title

MATERIAL SCHEDULE

NOT TO SCALE

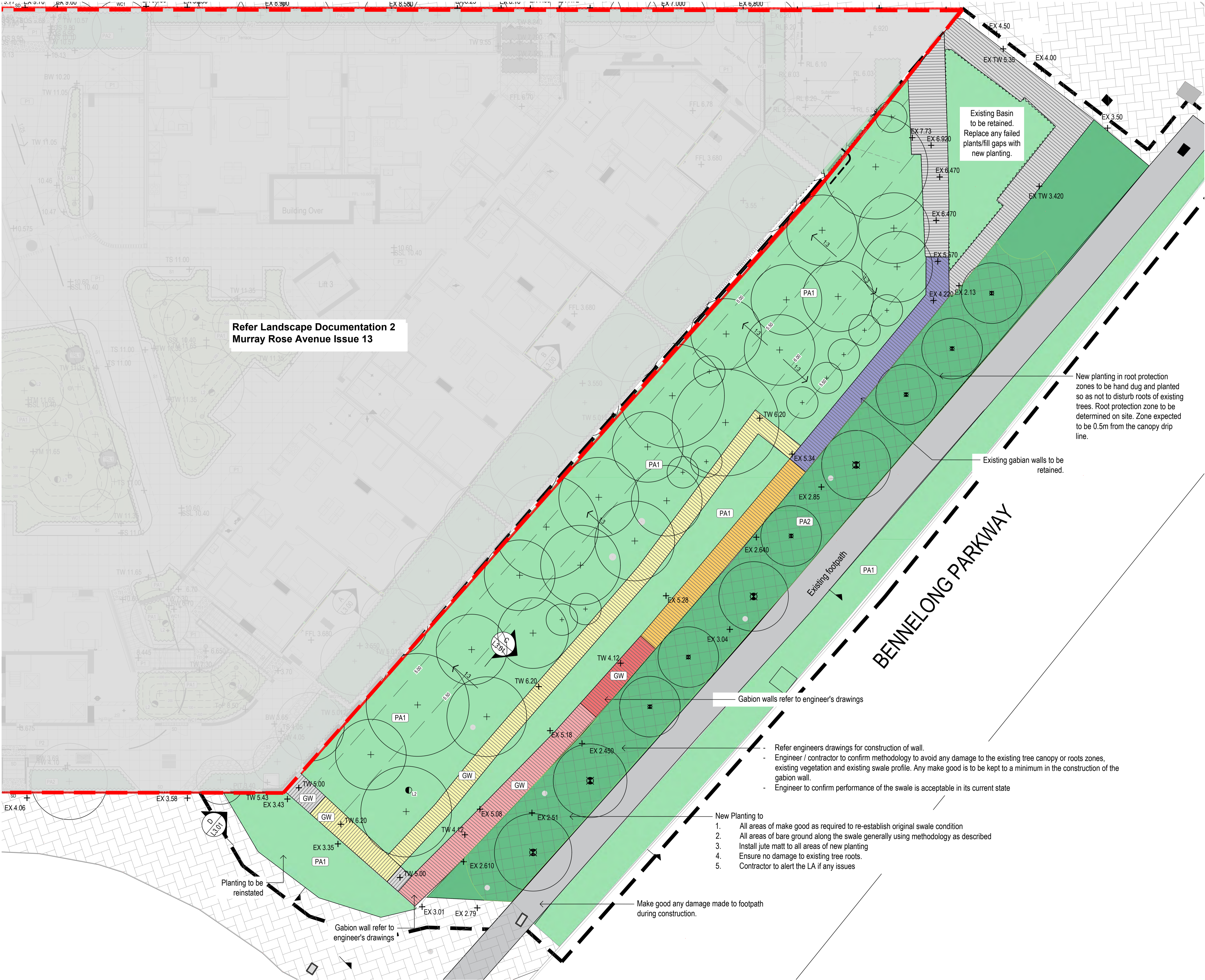

rev	description	date	drawn	QA
A	FOR APPROVAL	2024-08-30	RG	BR
B	FOR APPROVAL	2024-09-06	RG	SH
C	FOR APPROVAL	2025-02-11	RG	SH

NOT FOR CONSTRUCTION

Legend

General

- Extent of works
- Antara Project Property boundary

Grading

- EX 0.000 Existing surface level (in millimetres)
- 0.000 Relative surface level

Softscape

- Existing tree To be retained
- Tree Refer to Detail Refer Schedule
- Shrubs
- Planting area In ground (PA1)
- Planting area Swale planting (PA2)
- Root Protection Zones Hand planting

Hardscape

- Gabion wall Refer to Schedule (GW)

New planting in root protection zones to be hand dug and planted so as not to disturb roots of existing trees. Root protection zone to be determined on site. Zone expected to be 0.5m from the canopy drip line.

Existing gabion walls to be retained.

Gabion walls refer to engineer's drawings

- Refer engineers drawings for construction of wall.
- Engineer / contractor to confirm methodology to avoid any damage to the existing tree canopy or roots zones, existing vegetation and existing swale profile. Any make good is to be kept to a minimum in the construction of the gabion wall.
- Engineer to confirm performance of the swale is acceptable in its current state

- New Planting to
- All areas of make good as required to re-establish original swale condition
 - All areas of bare ground along the swale generally using methodology as described
 - Install jute matt to all areas of new planting
 - Ensure no damage to existing tree roots.
 - Contractor to alert the LA if any issues

Make good any damage made to footpath during construction.

Planting to be reinstated

Gabion wall refer to engineer's drawings



A TETRA TECH COMPANY

RPS AAP Consulting Pty Ltd
ABN 97 117 883 173

Sydney Office
Level 13, 420 George Street
Sydney NSW 2000

T +61 2 8099 3200
W rpsgroup.com

client
DECODE
project name
ANTARA - SOPA LAND
project location
BENNELONG PKY, SYDNEY OLYMPIC PARK
drawing title
LANDSCAPE PLAN



SOPA PLANT SCHEDULE							
CODE	SPECIES	COMMON NAME	POTSIZE	HTxSPRD	SPACING	SOPA LIST	QTY
TREES							
ALL TOR	ALLOCASUARINA TORULOSA	RIVER OAK	200L	8m x 5m	Refer plans		1
BAC MYR	BACKHOUSIA MYRTIFOLIA	CINNAMON MYRTLE	200L	40m x 10m	Refer plans		11
COR GUM	CORYMBIA GUMMIFERA	RED BLOODWOOD	200L	20-35m x 7m	Refer plans		6
EUC LON	EUCALYPTUS LONGIFOLIA	WOOLLYBUTT	200L	15m x 9m	Refer plans		4
EUC RAC	EUCALYPTUS RACEMOSA	NARROW-LEAVED SCRIBBLY GUM	200L	12m x 10m	Refer plans		4
LOP CON	LOPHOSTEMON CONFERTUS	BRUSH BOX	200L	25m x 15m	Refer plans		7
SHRUBS							
ACA LON	ACACIA LONGIFOLIA	COASTAL WATTLE	5L	5m x 4m	4/m2		87
BUR SPI	BURSARIA SPINOSA	SWEET BURSARIA	5L	4m x 2.5m	4/m2		87
CAL SIG	CALLISTEMON SALIGNUS	WILLOW BOTTLEBRUSH	45L	6m x 3m	2/m2		43
DOD TRI	DODONAEA TRIQUETRA	COMMON HOP BUSH	5L	2-3m x 2m	4/m2		87
DOR EXC	DORYANTHES EXCELSA	GYMEA LILY	5L	4m x 1.5m	4/m2		92
HAK SER	HAKEA SERICEA	BUSHY NEEDLEWOOD	25L	2m x 1.5m	3/m2		65
KUN AMB	KUNZEA AMBIGUA	WHITE TICK BUSH	5L	1.5m x 2.5m	4/m2		87
MEL DEC	MELALEUCA DECORA	HONEYMYRTLE	45L	5m x 3m	2/m2		43
OZO DIO	OZOTHAMNUS DIOSMIFOLIUS	DOGWOOD	25L	1-2m x 1.5m	3/m2		65
POL SAM	POLYSCIAS SAMBUCIFOLIA	ELDERBERRY PANAX	5L	2m x 1.5m	4/m2		87
GROUNDCOVERS							
DIC REP	DICHONDRA REPENS	KINDNEY WEED	5L	0.5 x 1.5m	5/m2		145
HAR VIO	HARDENBERGIA VIOLACEA	NATIVE SARSAPARILLA	5L	2m x 2m	5/m2		145
MYO BON	MYOPORUM BONINENSE	COASTAL BOOBIALLA	5L	0.2m x 2m	5/m2		145
GRASSES							
THE AUS	THEMEDA AUSTRALIS	KANGAROO GRASS	5L	1.5m x 0.5m	5/m2		130
AUS TEN	AUSTRODANTHONIA TENUIOR	WALLABY GRASS	5L	1m x 0.5m	5/m2		130
DIA LJ	DIANELLA CAERULEA 'LITTLE JESS'	FLAX LILY	5L	0.4m x 0.4m	5/m2		130
LOM MUL	LOMANDRA MULTIFLORA	MANY FLOWERED MAT-RUSH	5L	0.5m x 1m	5/m2		130
LOM TAN	LOMANDRA TANIKA	MAT RUSH	5L	0.65 x 0.65m	5/m2		182
LOM VER	LOMANDRA VERDAY	VERDAY MAT RUSH	5L	0.5m x 0.5m	5/m2		52
CAR INV	CAREX INVERSA	KNOB SEDGE	5L	0.5m x 0.3m	5/m2		52
CAR APP	CAREX APPRESSA	KNOB SEDGE	5L	0.75m x 0.75m	5/m2		154
SWALE PLANTING*							
CAR APP	CAREX APPRESSA	KNOB SEDGE	150mm	0.75m x 0.75m	9/m2		227
CAR INV	CAREX INVERSA	KNOB SEDGE	150mm	0.5m x 0.3m	9/m2		243
LOM TAN	LOMANDRA TANIKA	MAT RUSH	150mm	0.65 x 0.65m	9/m2		243
JUN POL	JUNCUS POLYANTHEMOS	AUSTRALIAN GRAY RUSH	150mm	0.7m x 0.5m	9/m2		243
NOTE:							
The contractor shall review the plant schedule to ensure that drawings and schedules concur. Where insufficient detail or discrepancies may exist on either the plans or the schedule, it is the contractors responsibility to resolve immediately with the Landscape Architect and prior to providing tender pricing, signing work contracts							
*SWALE -							
Due to the extent of root zones, unknown area of make good and exact area of existing planting, all plant numbers shown on the swale plant schedule are an estimate only. Increased numbers may be required to the swale and the contractor is to ensure that all areas of the swale are planted to the densities shown.							

rev	description	date	drawn	QA
A	FOR APPROVAL	2024-08-30	RG	BR
B	FOR APPROVAL	2024-12-17	RG	SH
C	FOR APPROVAL	2025-02-11	RG	SH

NOT FOR CONSTRUCTION



RPS AAP Consulting Pty Ltd
ABN 97 117 883 173

Sydney Office
Level 13, 420 George Street
Sydney NSW 2000

T +61 2 8099 3200
W rpsgroup.com

client

DECODE

project name

ANTARA - SOPA LAND

project location

BENNELONG PKY, SYDNEY OLYMPIC PARK

drawing title

PLANTING SCHEDULE

NOT TO SCALE

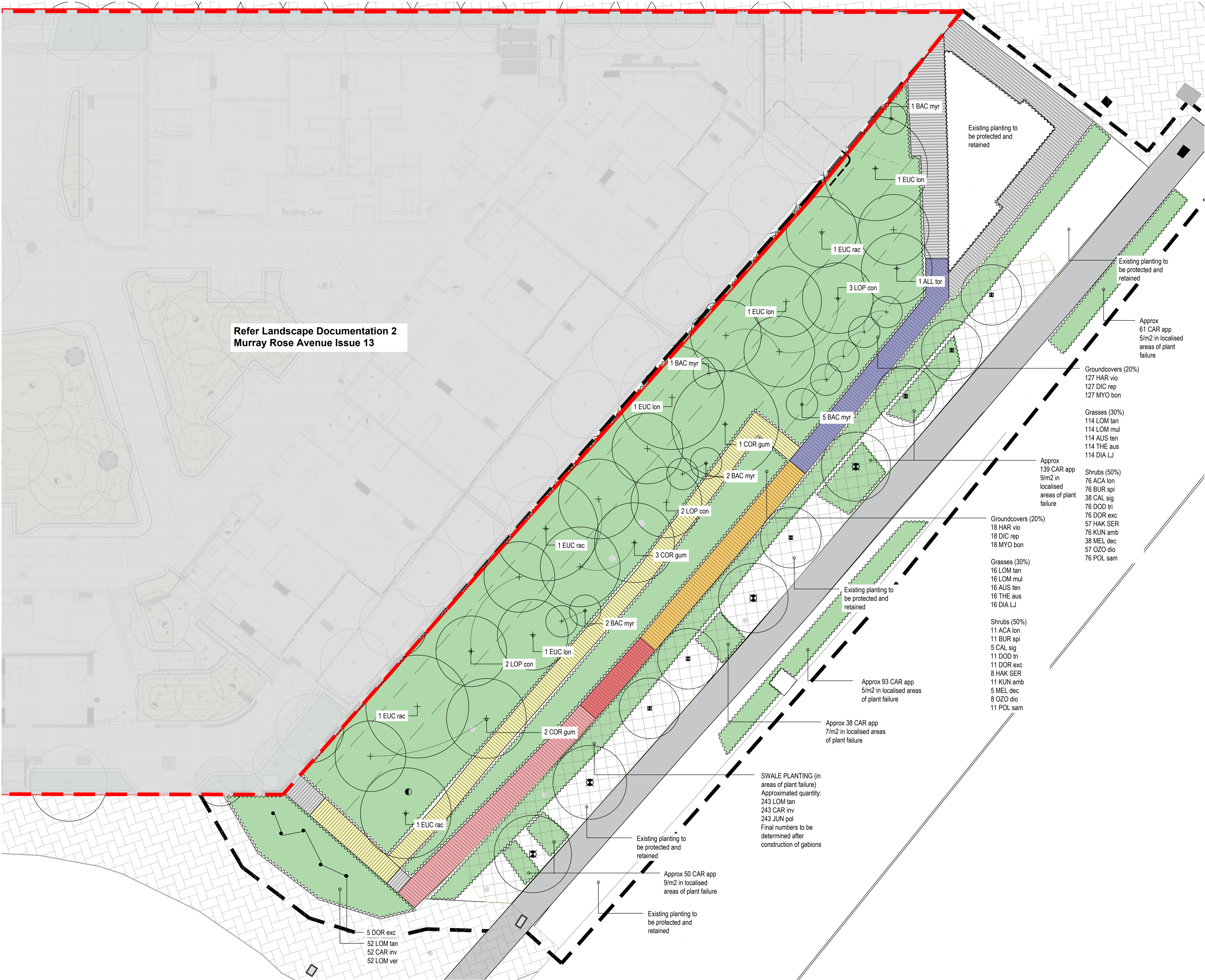

Refer Landscape Documentation 2
Murray Rose Avenue Issue 13

rev	description	date	drawn	QA
A	FOR APPROVAL	2024-08-30	RG	BR
B	FOR APPROVAL	2024-12-17	RG	SH
C	FOR APPROVAL	2025-02-11	RG	SH

NOT FOR CONSTRUCTION

- Extent of works
- Antara Project Property boundary
- Existing tree
To be retained
- Tree
Refer to Detail
Refer Schedule
- Shrubs
- Root Protection Zones
Hand planting
- New Planting area

Groundcovers (20%)
127 HAR vio
127 DIC rep
127 MYO bon

Grasses (30%)
114 LOM tan
114 LOM mul
114 AUS ten
114 THE aus
114 DIA LJ

Shrubs (50%)
76 ACA lon
76 BUR spi
38 CAL sig
76 DOD tri
76 DOR exc
57 HAK SER
76 KUN amb
38 MEL dec
57 OZO dio
76 POL sam

Groundcovers (20%)
18 HAR vio
18 DIC rep
18 MYO bon

Grasses (30%)
16 LOM tan
16 LOM mul
16 AUS ten
16 THE aus
16 DIA LJ

Shrubs (50%)
11 ACA lon
11 BUR spi
5 CAL sig
11 DOD tri
11 DOR exc
8 HAK SER
11 KUN amb
5 MEL dec
8 OZO dio
11 POL sam

SWALE PLANTING (in
areas of plant failure)
Approximated quantity:
243 LOM tan
243 CAR inv
243 JUN pol
Final numbers to be
determined after
construction of gabions

rps
A TETRA TECH COMPANY

RPS AAP Consulting Pty Ltd
ABN 97 117 883 173

Sydney Office
Level 13, 420 George Street
Sydney NSW 2000

T +61 2 8099 3200
W rpsgroup.com

client

DECODE

project name

ANTARA - SOPA LAND

project location

BENNELONG PKY, SYDNEY OLYMPIC PARK

drawing title

PLANTING PLAN

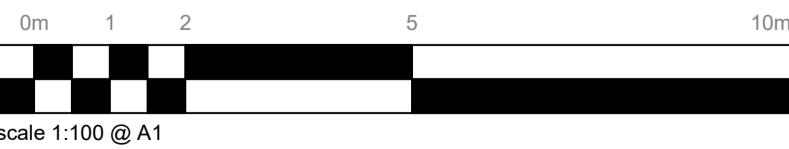

rev	description	date	drawn	QA
A	FOR APPROVAL	2024-09-06	RG	SH
B	FOR APPROVAL	2024-12-17	RG	SH
C	FOR APPROVAL	2025-02-11	RG	SH

NOT FOR CONSTRUCTION

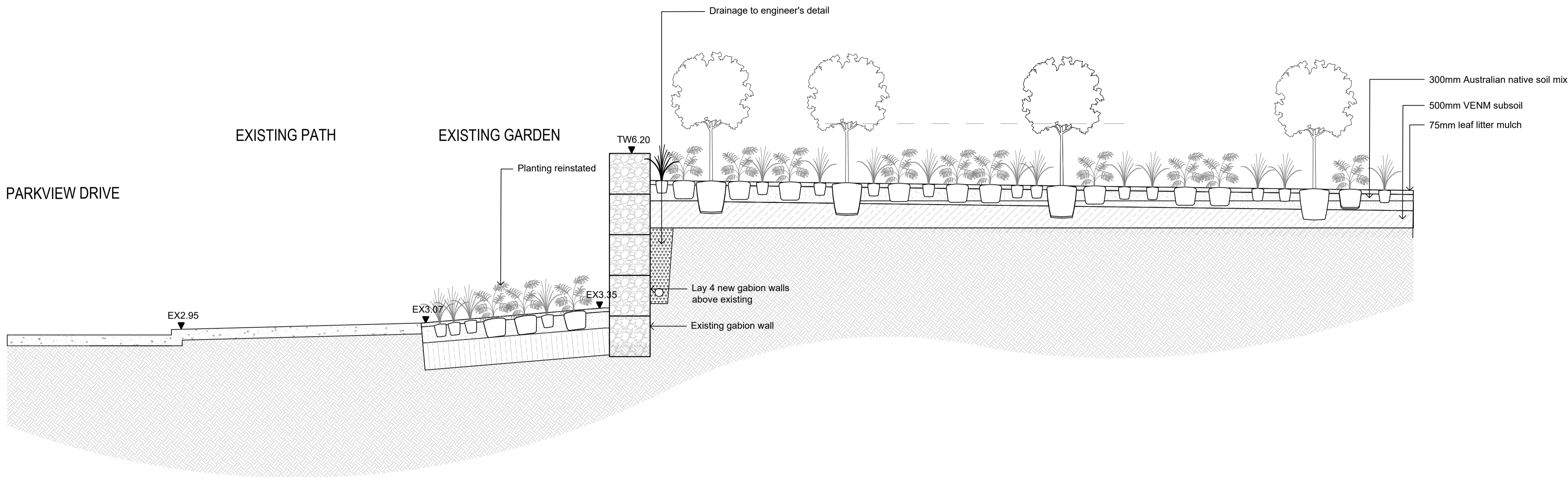
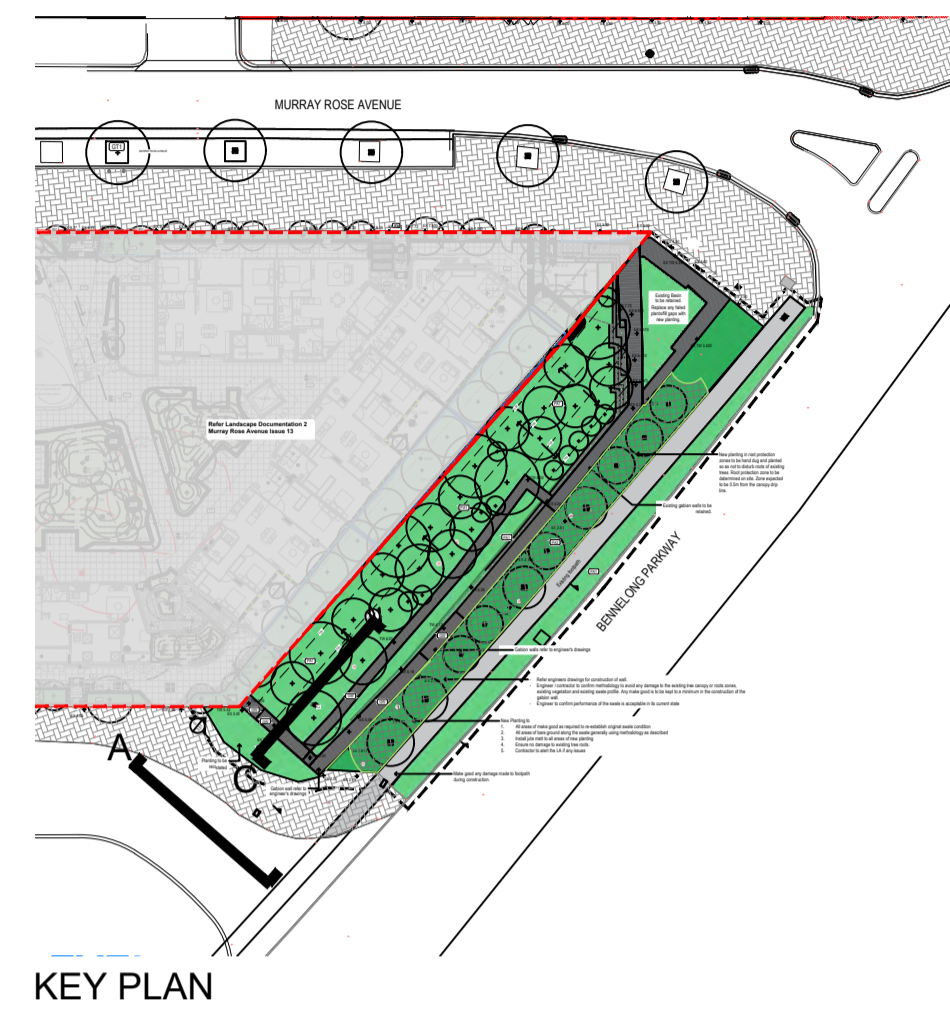

SECTION C

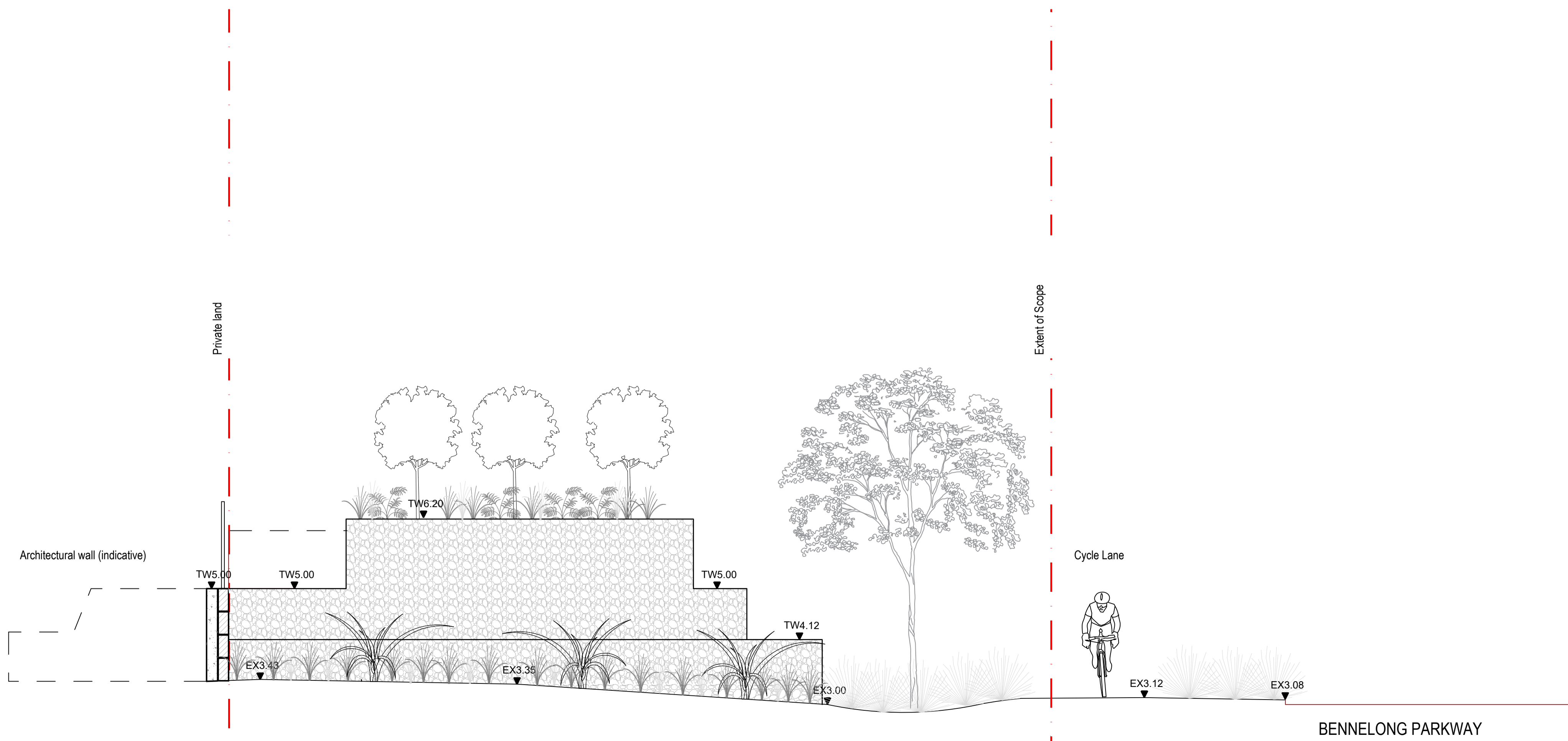

ELEVATION A



A TETRA TECH COMPANY

RPS AAP Consulting Pty Ltd
ABN 97 117 883 173

Sydney Office
Level 13, 420 George Street
Sydney NSW 2000

T +61 2 8099 3200
W rpsgroup.com

client

DECODE

project name

ANTARA - SOPA LAND

project location

BENNELONG PKY, SYDNEY OLYMPIC PARK

drawing title

SECTION AND ELEVATION

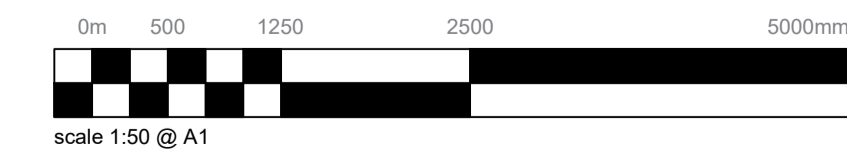

NOT FOR CONSTRUCTION

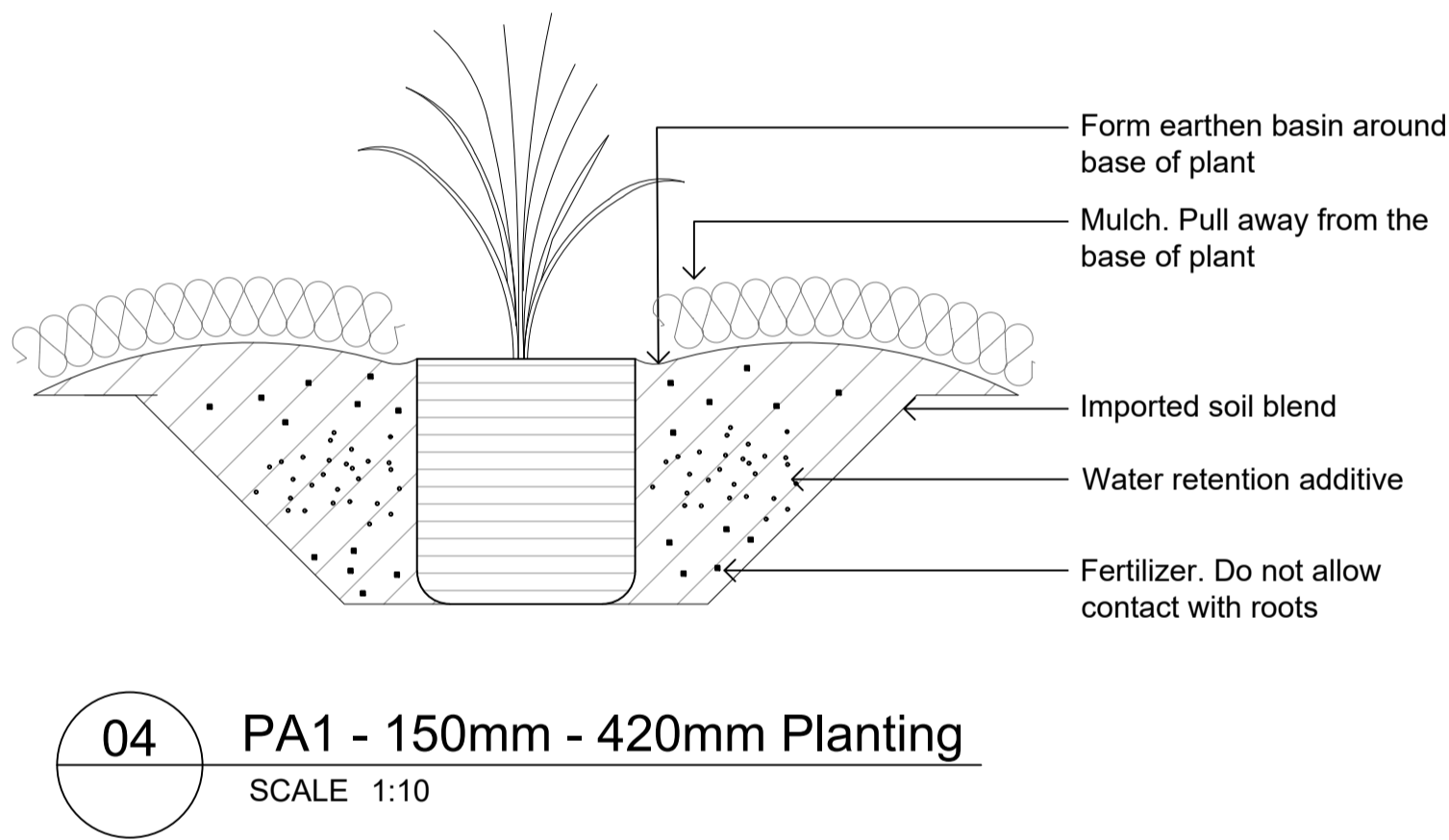
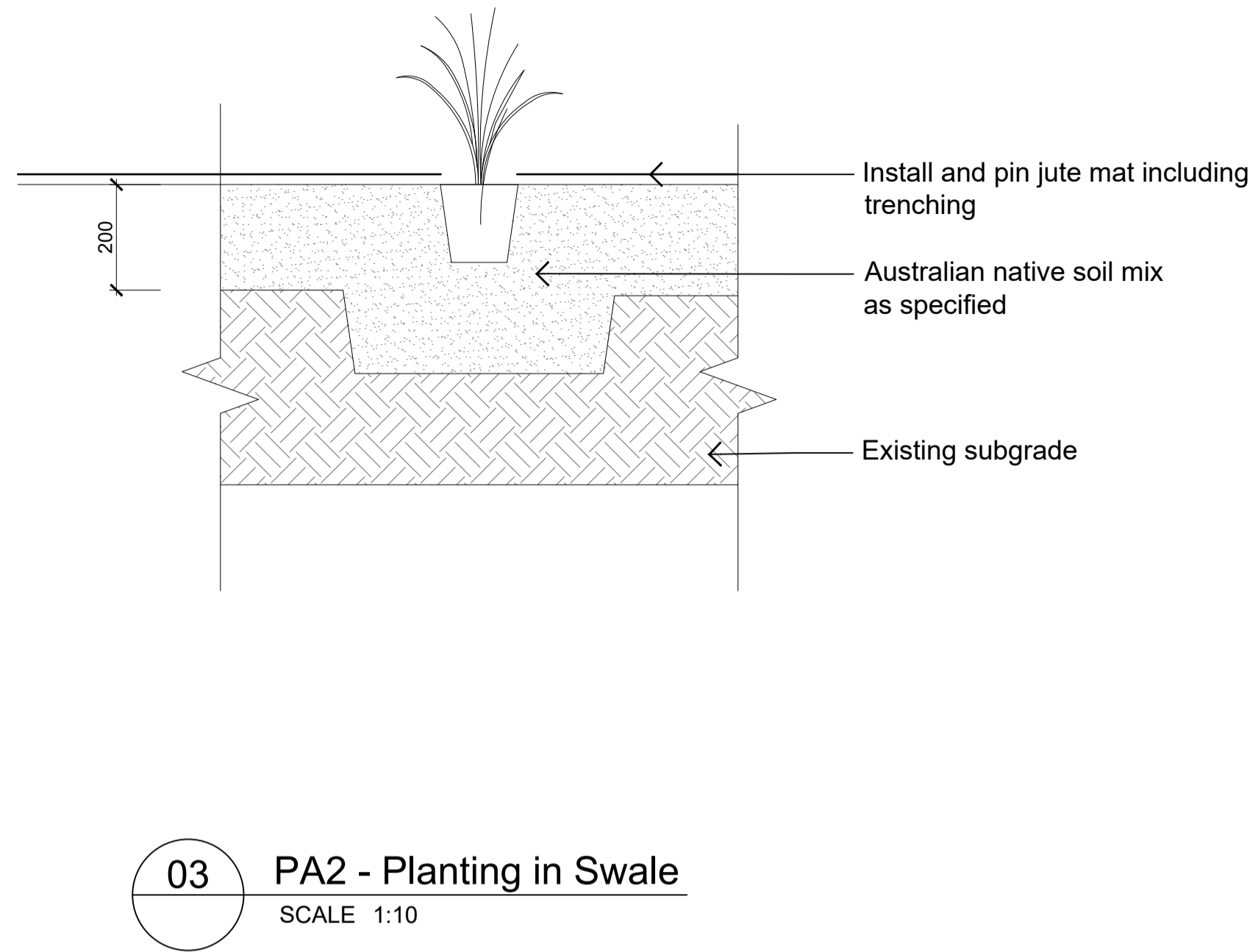
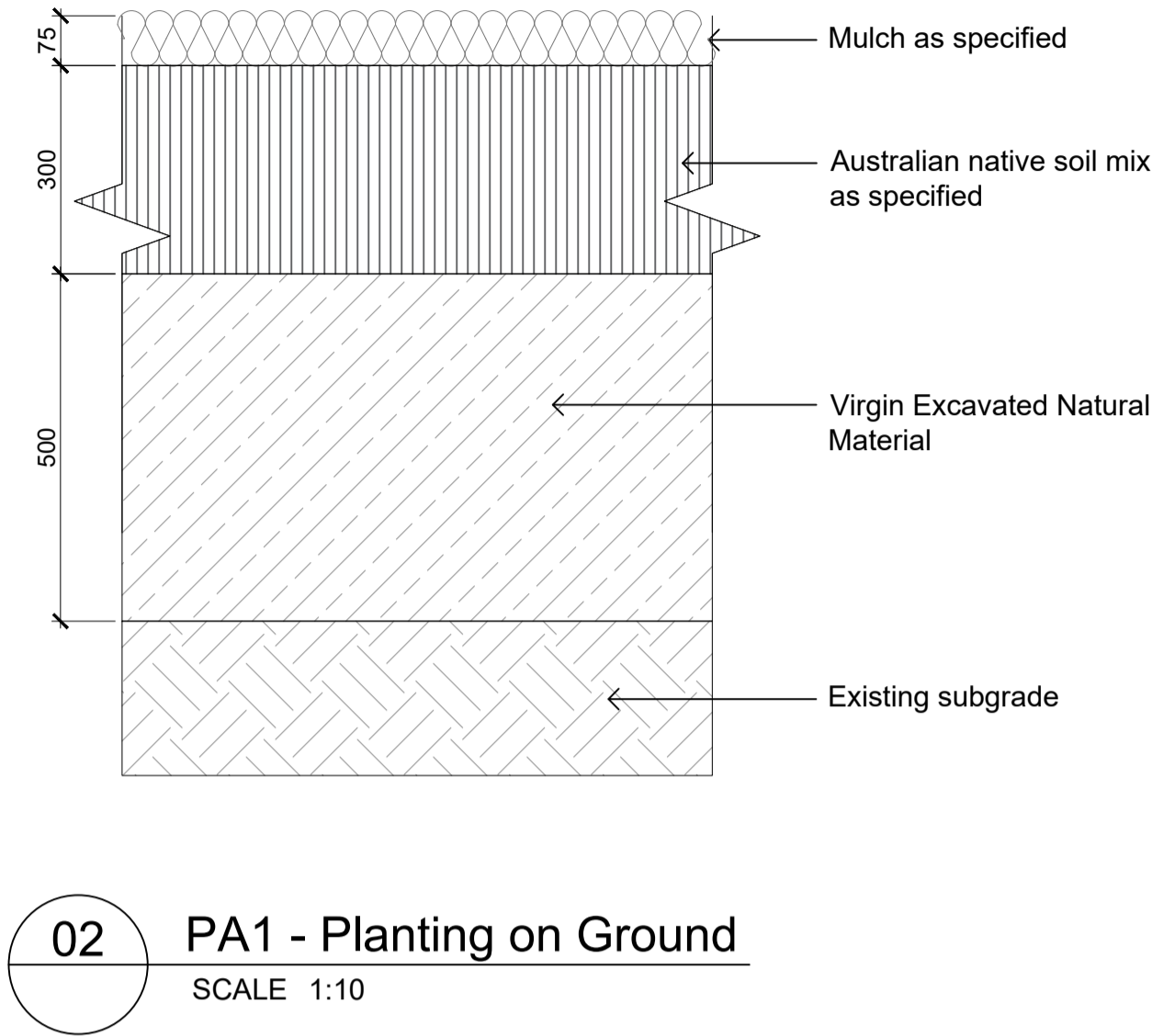
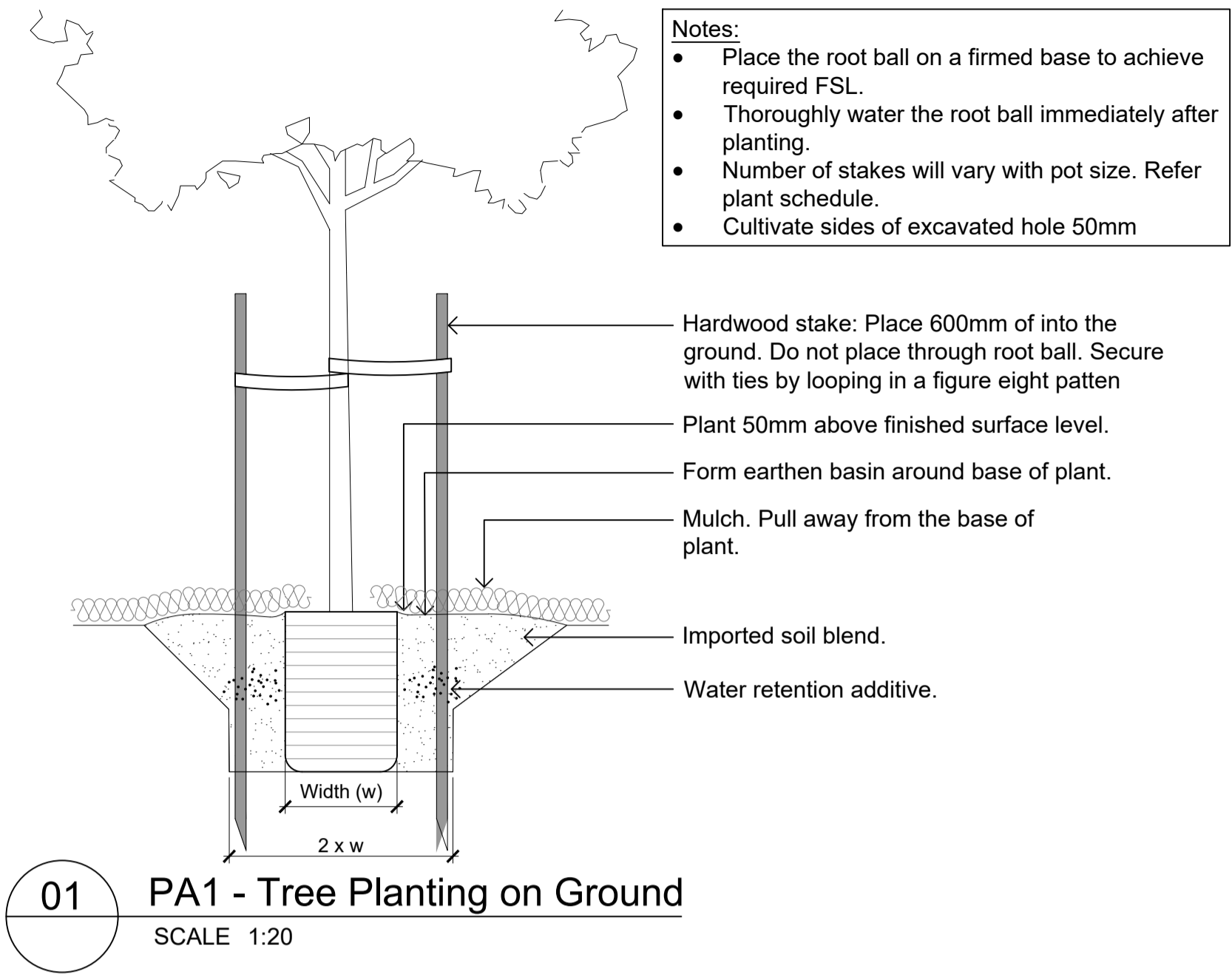

AS SHOWN

scale